

Beginning at a Buckhorn
 creek in the Bank of Lycoming
 and Creek thence S. 12. E. 63. -
 543 1/2 E. - 94 8. 2 E. 40. - South
 60. - S 38 1/2 W 24. - S 20 1/2 W 27. -
 S 52 3/4 W 44. - S. 8 E 18. 9. S 4 1/2
 W 12. -

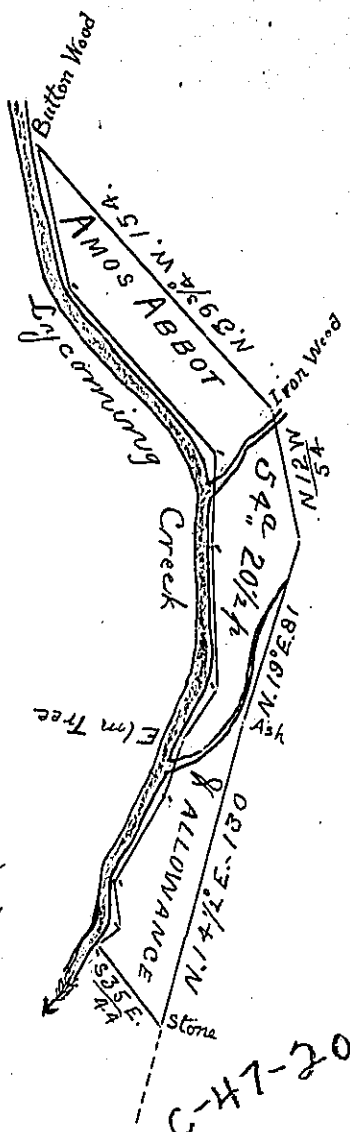

ROBERT FARIS

202-14-3

Surveyed the above tract of land for
 Amos Abbot on the 6th Day of August 1835
 in pursuance of his warrant dated the 15th
 Day of April 1833. Situate in Elkland Town-
 ship, Lycoming County. Containing fifty
 four acres, twenty perches & a half, & the usual
 allowance of six pr. ct. for Roads &c.

David Hanna D.S.

To Jacob Spangler
 Surveyor Genl.

Note: The improvements, are a small frame
 house and log barn, with about 30 acres of
 cleared land.

IN TESTIMONY that the above is a copy of the original remaining on file in
 the Department of Internal Affairs of Pennsylvania, made
 conformably to an Act of Assembly approved the 16th day of
 February, 1833, I have hereunto set my Hand and caused
 the Seal of said Department to be affixed at Harrisburg,
 this seventeenth day of August 1903.

Geo. R. Brown
 Secretary of Internal Affairs.